

Kettingwielen 08B-1/2/3

1/2" x 5/16" (mat. Staal)

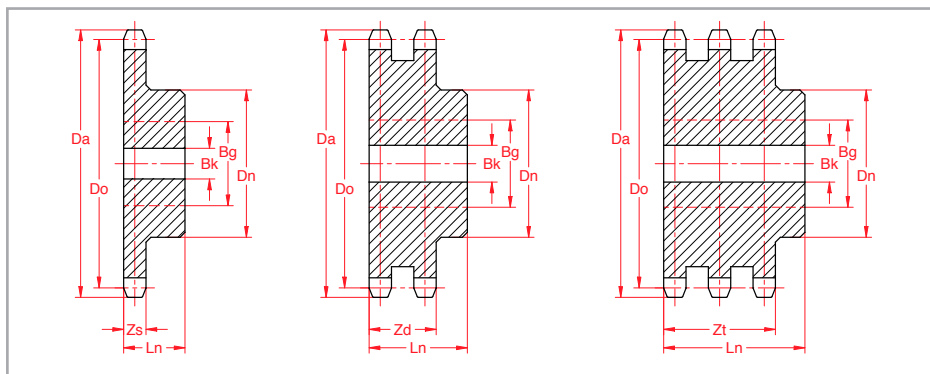

Z	D _o	D _a	Simplex z _s = 7,1			Duplex z _d = 21			Triplex z _t = 34,9		
			D _n	L _n	B _k /B _g	D _n	L _n	B _k /B _g	D _n	L _n	B _k /B _g
8	33,18	38,0	20	25	10/12	20	32	10/12	20	46	10/12
9	37,13	42,0	24	25	10/13	24	32	10/13	24	46	12/13
10	41,10	45,9	26	25	10/13	28	32	10/15	28	46	12/15
11	45,07	49,9	29	25	10/15	32	35	12/16	32	50	16/16
12	49,07	53,9	33	28	10/16	35	35	12/20	35	50	16/20
13	53,06	57,9	37	28	10/20	38	35	12/20	38	50	16/20
14	57,07	61,9	41	28	10/25	42	35	12/25	42	50	16/25
15	61,09	65,9	45	28	10/25	46	35	12/25	46	50	16/25
16	65,10	69,9	50	28	12/32	50	38	16/32	50	50	16/32
17	69,11	74,0	52	28	12/32	54	38	16/32	54	50	16/32
18	73,14	78,0	56	28	12/35	58	38	16/35	58	50	16/35
19	77,16	82,0	60	28	12/38	62	38	16/38	62	50	16/38
20	81,19	86,0	64	28	12/40	66	38	16/40	66	50	16/40
21	85,22	90,1	68	28	14/45	70	40	16/45	70	55	16/45
22	89,24	94,1	70	28	14/45	70	40	16/45	70	55	16/45
23	93,27	98,1	70	28	14/45	70	40	16/45	70	55	16/45
24	97,29	102,1	70	28	14/45	75	40	16/45	75	55	16/45
25	101,33	106,2	70	28	14/45	80	40	16/50	80	55	16/50
26	105,36	110,2	70	30	16/45	85	40	16/55	85	55	20/55
27	109,40	114,2	70	30	16/45	85	40	16/55	85	55	20/55
28	113,42	118,3	70	30	16/45	90	40	16/60	90	55	20/60
29	117,46	122,3	80	30	16/50	95	40	16/60	95	55	20/60
30	121,50	126,3	80	30	16/50	100	40	16/60	100	55	20/60
31	125,54	130,4	90	30	16/60	100	40	20/60	110	55	20/60
32	129,56	134,4	90	30	16/60	100	40	20/60	110	55	20/60
33	133,60	138,4	90	30	16/60	100	40	20/60	110	55	20/60
34	137,64	142,5	90	30	16/60	100	40	20/60	110	55	20/60
35	141,68	146,5	90	30	16/60	100	40	20/60	110	55	20/60
36	145,72	150,6	90	35	16/60	100	40	20/60	120	55	25/70
37	149,76	154,6	90	35	16/60	100	40	20/60	120	55	25/70
38	153,80	158,6	90	35	16/60	100	40	20/60	120	55	25/70
39	157,83	162,7	90	35	16/60	100	40	20/60	120	55	25/70
40	161,87	166,7	90	35	16/60	100	40	20/60	120	55	25/70